

ELEVATION ALONG COLUMN LINE 13

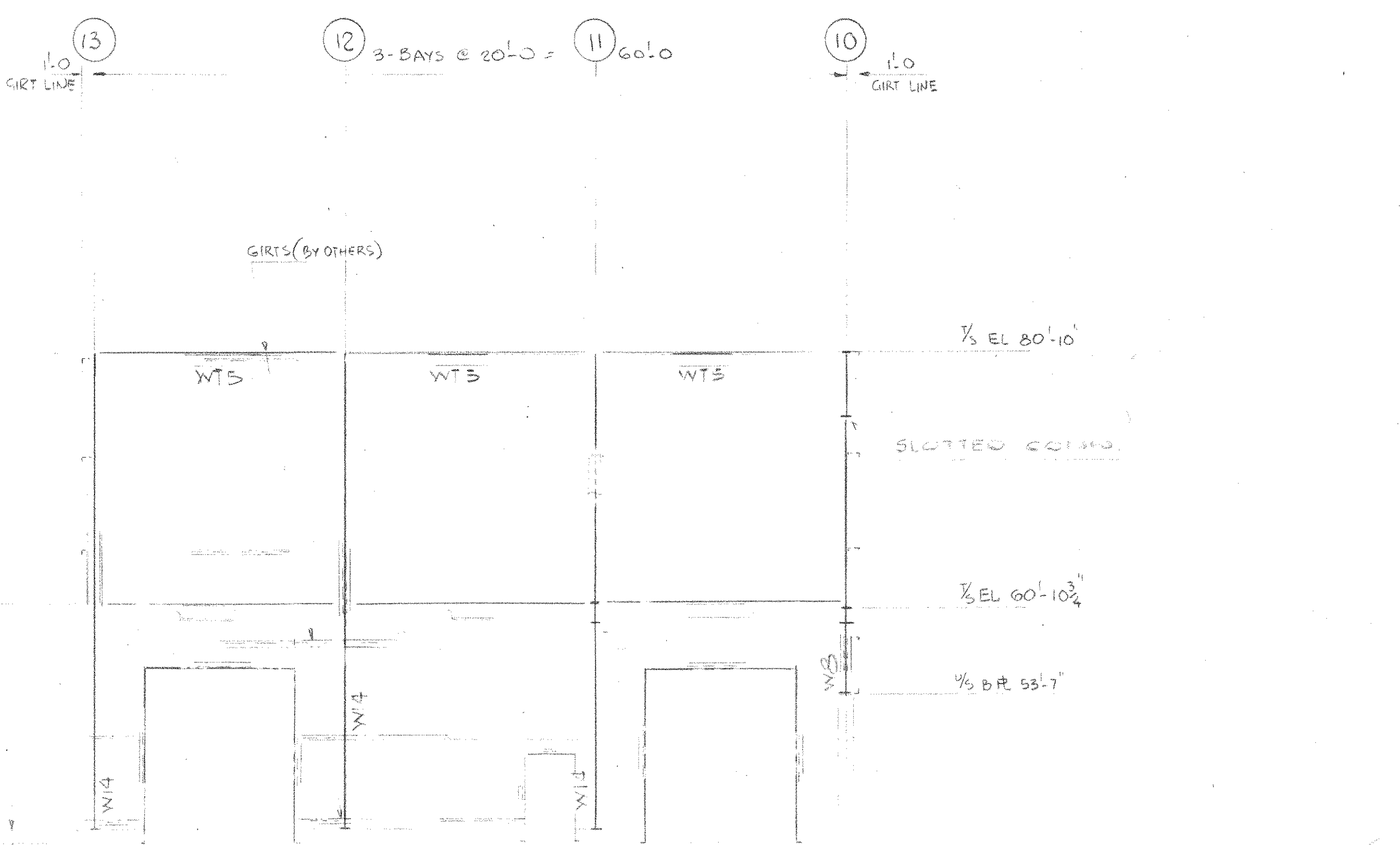

ELEVATION ALONG COLUMN LINE 1



ELEVATION ALONG COLUMN LINE A

3	ORIGINAL TRANSFERRED TO C.S.I.	NOV 19/86	KL
2	REVISION ON LINE 13 UPDATES		
1	CHIMNEY ON EL LINE 13	06/08/19	
0	ISSUED FOR CONSTRUCTION	06/25/86	
P2	ISSUED FOR DESIGN		
N2	REVISION		

TEMPORARY PERMIT NO. 771
TO PRACTICE ENGINEERING IN
THE STATE OF MARYLAND

W.P. LONDON AND ASSOCIATES LIMITED
CONSULTING ENGINEERS
NIAGARA FALLS

HARFORD COUNTY RESOURCE RECOVERY FACILITY - HARFORD COUNTY, MARYLAND

ELEVATIONS SHEET 3

Consumat Systems, Inc.
RICHMOND, VIRGINIA U.S.A.

SCALE	1/4" = 1'-0"	DRAWN	KL	DRAWING NO.	
DATE		CHK	KL	1624	PROJ-44512
DO NOT SCALE		APPR		SHEET	OF