

NOTE:
 1. THIS DWG. TO BE READ IN CONJUNCTION WITH DWG. NO. 42D1-011.
 2. FOR GENERAL NOTES SEE DWG. 42D1-005.

NOTE
 FOR HOLDING TANK LOCATION
 SEE DWG. NO. 41D2-001

PLAN OF HOLDING TANK
 (SCALE 3/8" = 1'-0")

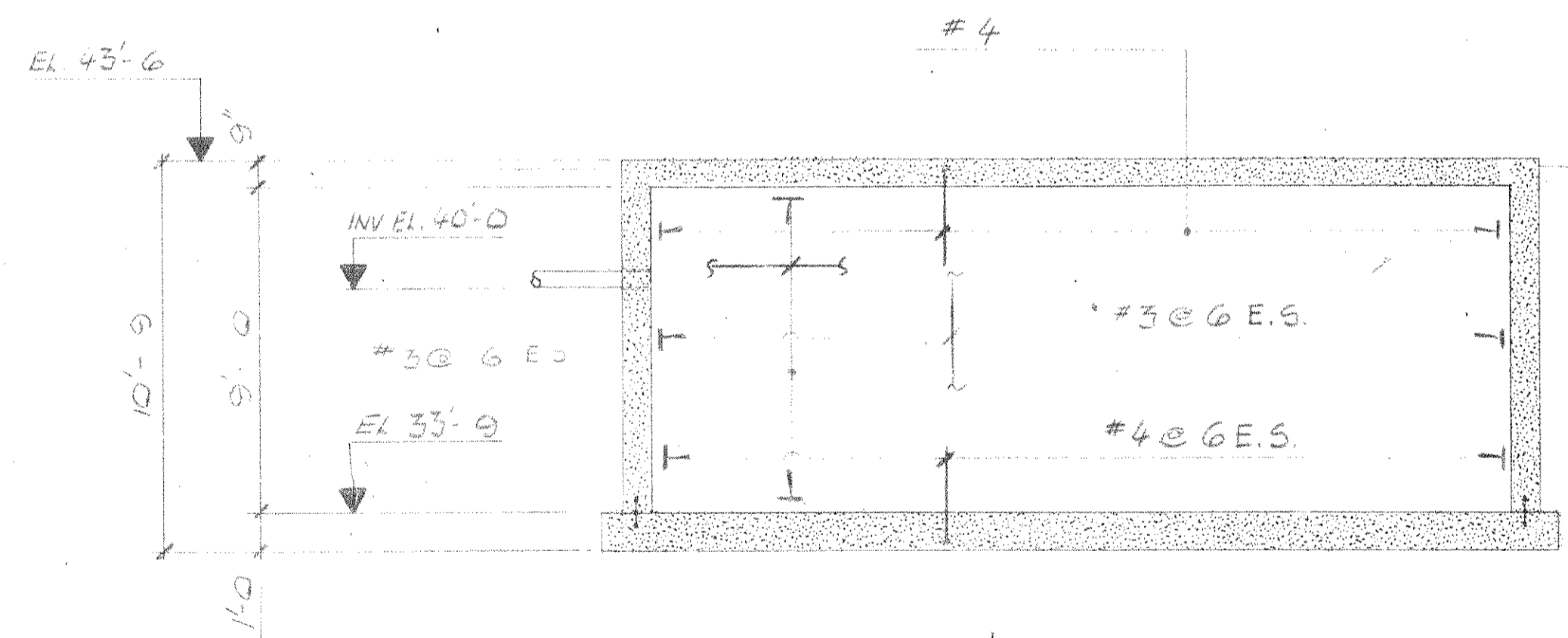

STANDARD 24" MANHOLE FRAME AND COVER DESIGN FOR HS 20 LOAD

SECTION 2
 (SCALE 3/8" = 1'-0")

3/4" GALV. SAFETY LADDER RUNGS @ 12" OC (TYP)

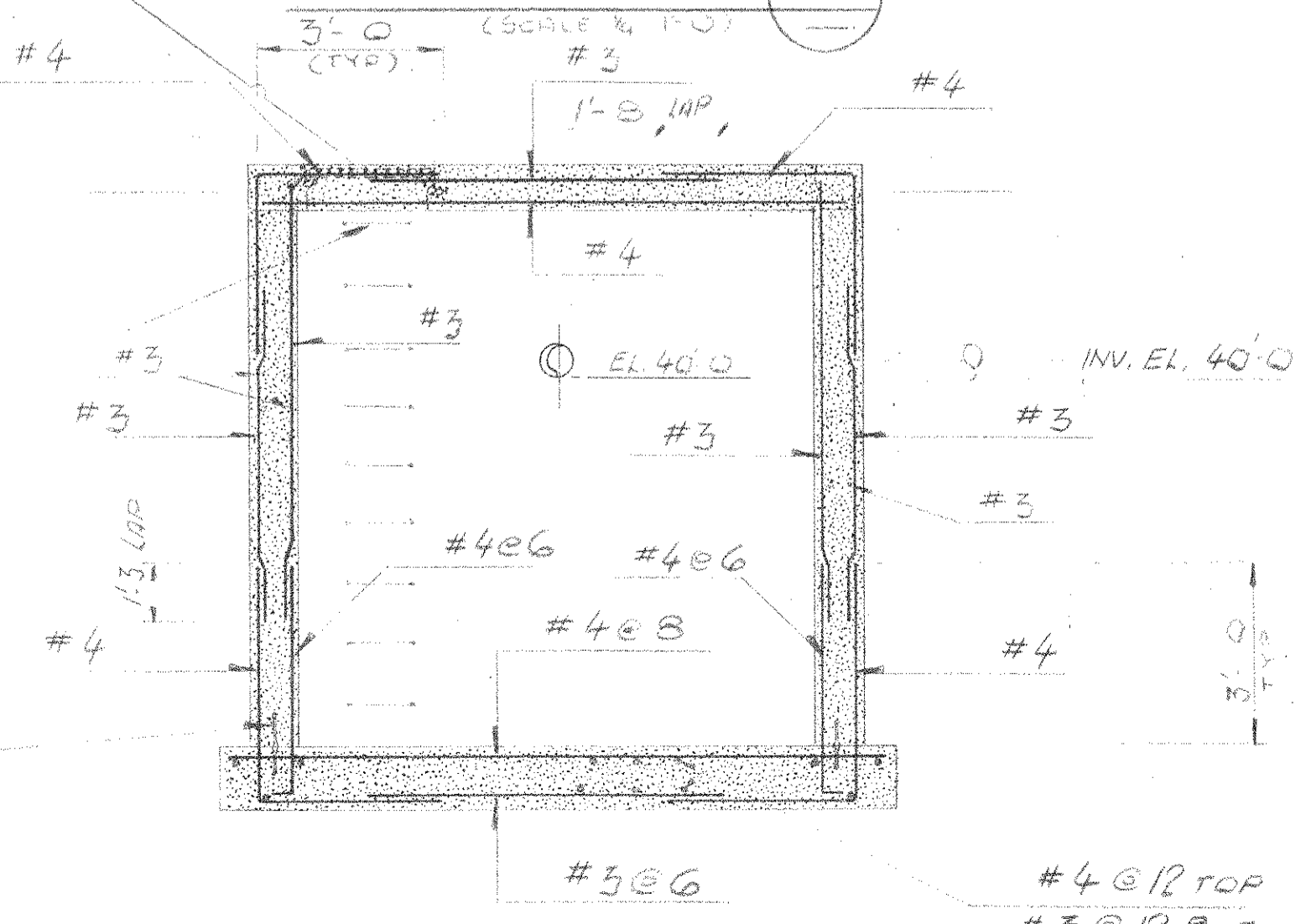

SECTION 1
 (SCALE 3/8" = 1'-0")

W.P. London

TEMPORARY PERMIT NO. 771 TO PRACTICE ENGINEERING IN THE STATE OF MARYLAND

W.P. LONDON AND ASSOCIATES LIMITED CONSULTING ENGINEERS NIAGARA FALLS			
HARFORD COUNTY RESOURCE RECOVERY FACILITY - HARFORD COUNTY, MARYLAND			
HOLDING TANK REINFORCED CONCRETE DETAILS			
Consumat Systems, Inc. RICHMOND, VIRGINIA U.S.A.		DRAWING NO. No 24-0000-42D1-015	
SCALE AS NOTED	DRAWN BY KSP/MSJ	DATE	REV. 2
DATE	CHK. ALARL	BY	OF
DO NOT SCALE	APPR.	SHEET	OF

NO.	REVISION	DATE	BY
2	ORIGINAL TRANSFERRED TO C.S.I.	NOV 19/86	KL
1	SEC. 3, REVISED		
0	ISSUED FOR CONSTRUCTION	17/00/86	