

ELEVATION ALONG COL LINE 13

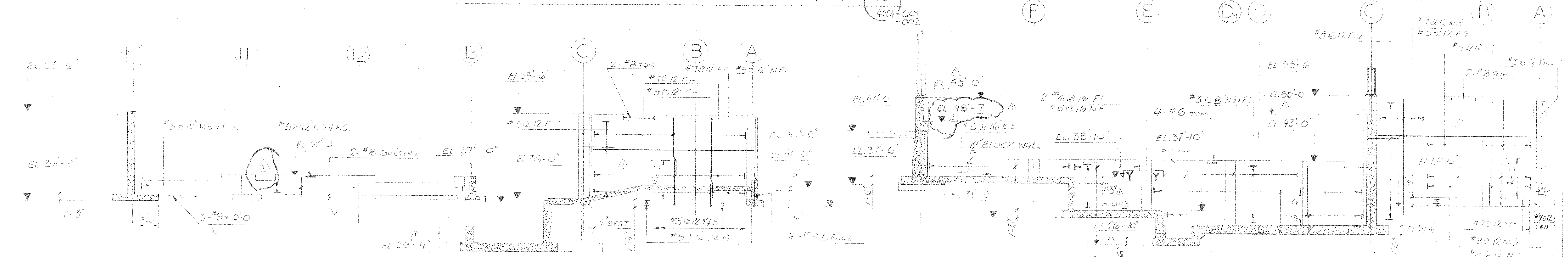

ELEVATION ALONG COL LINE A

ELEVATION ALONG COL LINE 10

ELEVATION ALONG COL LINE 3

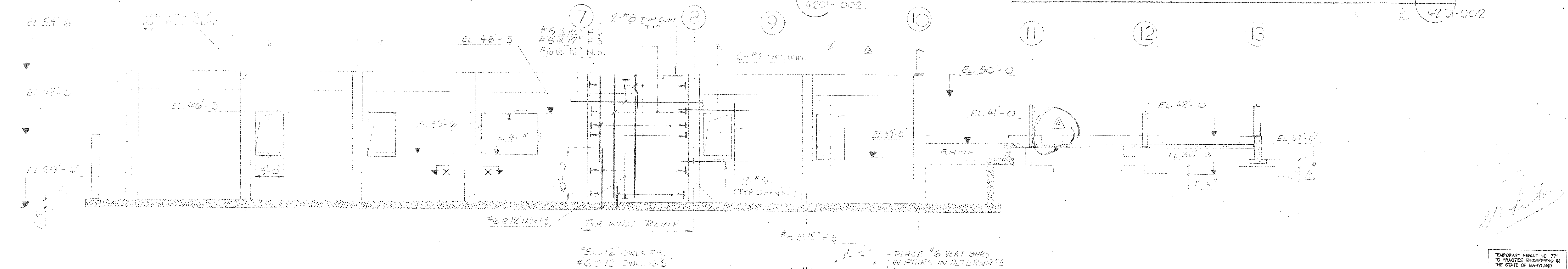

ELEVATION ALONG COL LINE C

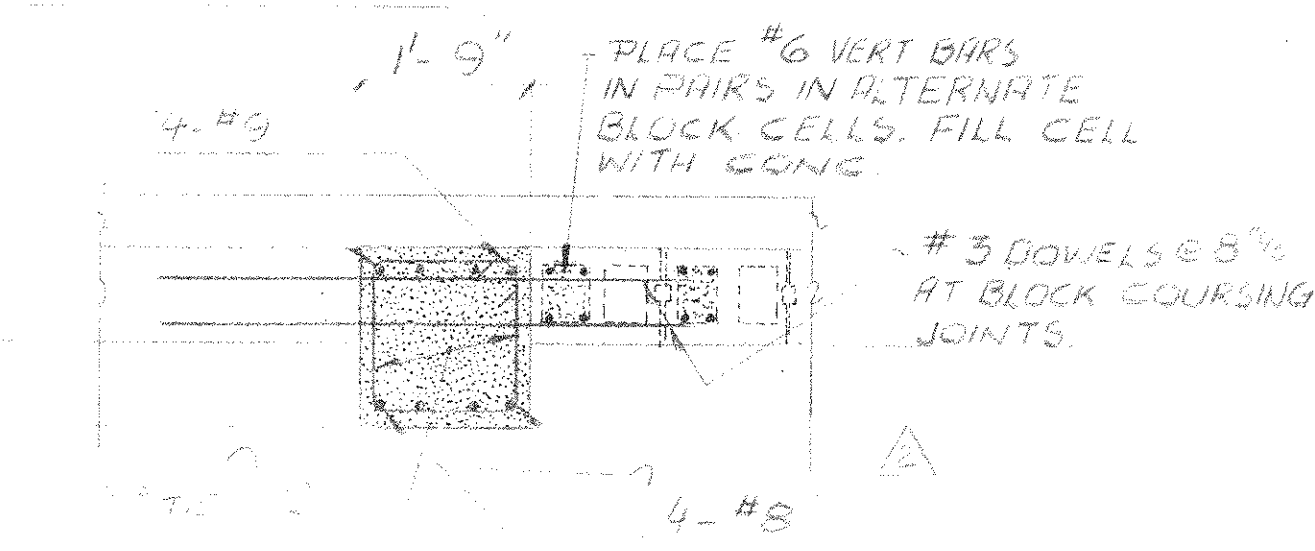

5	ORIGINAL TRANSFERRED TO C.S.I.	Nov 19/86	KL
4	EL. ON COL LINE 3 REVISED TO SUIT PLATFORM LEVEL.		
3	REVISED AS NOTED	5/11/87	KL
2	ELEVATION COL LINE 3 REVISED	08/18/86	KL
1	REVISION AS SHOWN HEREIN	01/15/86	KL
C	REMOVED ABOVE EL. 51'-0"	11/18/86	KL
	RELEASED FOR CONSTRUCTION UP TO EL. 51'-0"	11/18/86	KL
NO	DATE	DATE	DATE

W.P. LONDON AND ASSOCIATES LIMITED  
CONSULTING ENGINEERS  
NIAGARA FALLS

HARFORD COUNTY RESOURCE RECOVERY FACILITY - HARFORD COUNTY, MARYLAND

WALL ELEVATIONS

**Consumat Systems, Inc.**  
RICHMOND, VIRGINIA U.S.A.

SCALE: 1/4" = 1'-0"	DRAWN: K. KORSAK	DRAWING NO.
DATE: 3/20/87	CHK: [Signature]	1624-0002-4/2D-001
DO NOT SCALE	APPR: [Signature]	SHEET 2 OF 2

*W.P. London*

TEMPORARY PERMIT NO. 771  
TO PRACTICE ENGINEERING IN  
THE STATE OF MARYLAND